

1.Warning:

1. Professional installation required.
2. Disconnect power before installation.
3. Follow national installation regulations.
4. Install product away from heat sources and flammable materials.
5. Ensure neat, non-crossing wiring with proper grounding.
6. When climbing, have supervision and use anti-slip measures.

Embedded Installation Diagram:

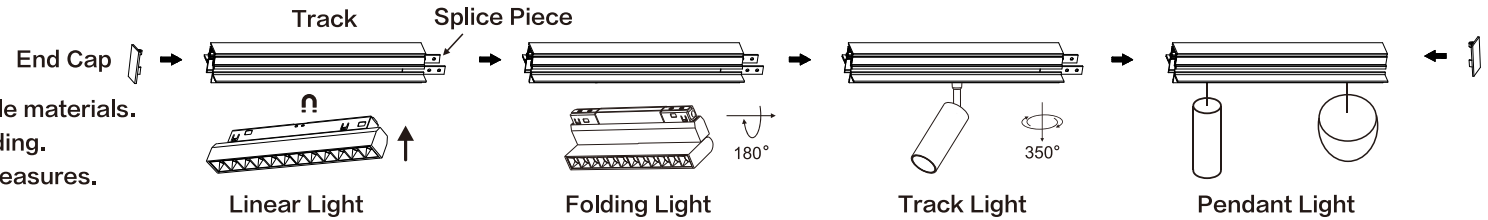

2.Product structural diagram:

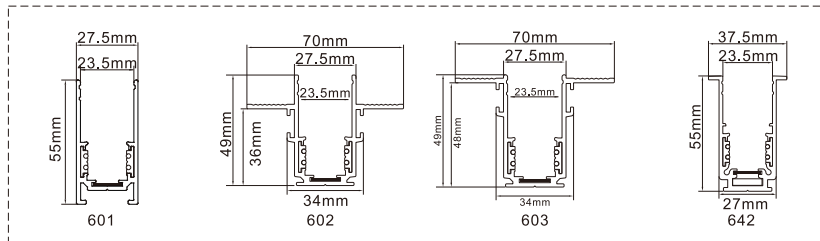

3.End cap installation guide:

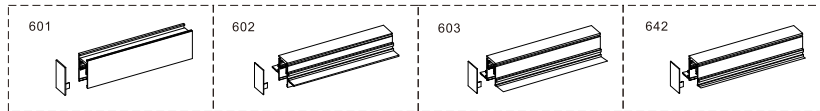

The end cap is used at the beginning and end of the track and needs to be firmly fixed in place.

4.Track connection diagram:

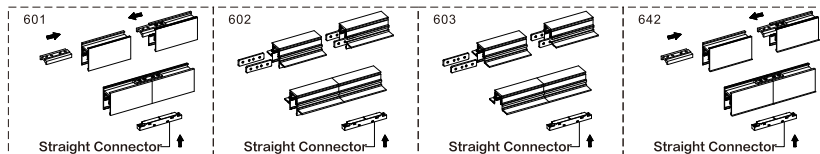

Straight connectors are used to conduct electricity at the junction of two tracks and are compatible with all types of tracks.

L-shaped corner connection instructions L-shaped internal corner conductive instruction

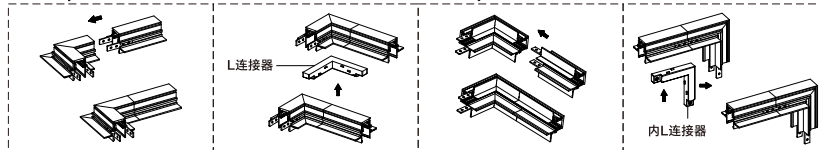

Their installation method is suitable for installation on all tracks.

5.Track power supply schematic:

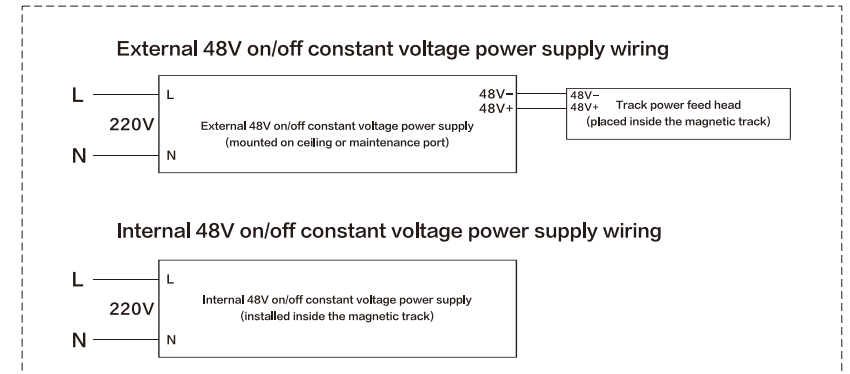

6.Embedded track installation instructions:

602 embedded pressure plate track:

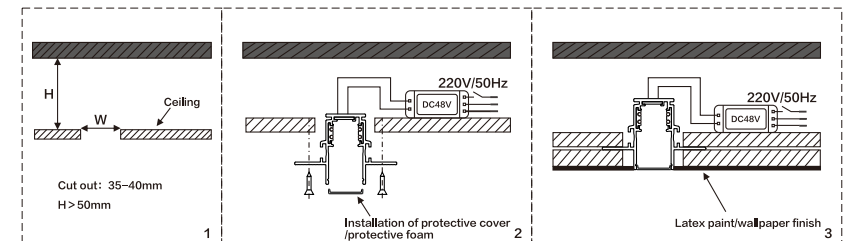

1. Drill holes on the ceiling according to the track dimensions. (Figure 1)
2. Secure the track to the wooden board using screws as instructed. (Figure 2)
3. Add gypsum board at the bottom and secure it with screws. (Figure 3)
4. After completing the ceiling finish, remove the protective foam inside the track. (Figure 3)

1.Warning:

1. Professional installation required.
2. Disconnect power before installation.
3. Follow national installation regulations.
4. Install product away from heat sources and flammable materials.
5. Ensure neat, non-crossing wiring with proper grounding.
6. When climbing, have supervision and use anti-slip measures.

Surface-mounted/Suspended installation schematic:

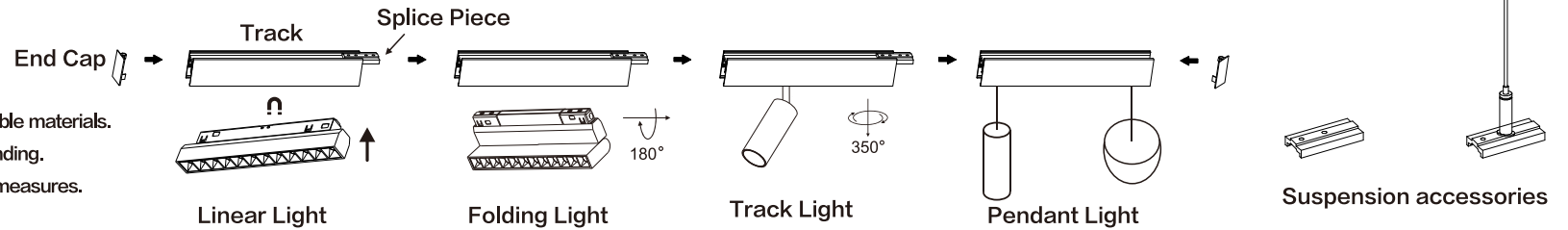

6.Embedded track installation instructions:

603 Plaster embedded installation:

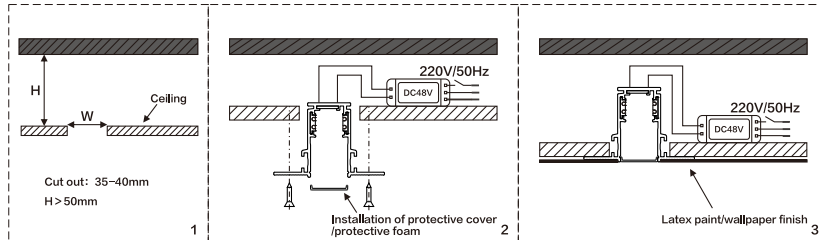

1. Drill holes on the ceiling according to the track dimensions. (Figure 1)
2. Use self-tapping screws to fix the track in the installation groove on the ceiling. (Figure 3)
3. After completing the ceiling finish, remove the protective foam inside the track. (Figure 3)

642 free plaster embedded:

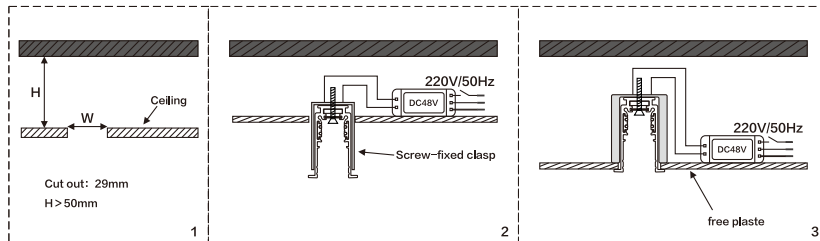

1. Drill holes on the ceiling according to the track dimensions. (Figure 1)
2. Secure the track inside the clasp using screws. (Figure 2)
3. Rotate the screws of the fixed clasp until the bottom of the clasp is pressed against the ceiling. (Figure 3)

7.Installation instructions for suspended/surface-mounted tracks:

601 638 suspended installation

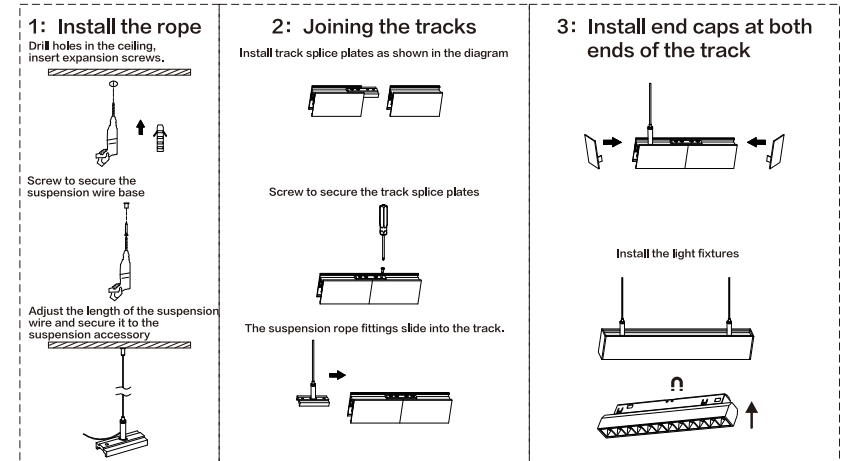

601 638 surface-mounted installation

